

<b>ICE 80A Pedestal Mounting</b>	<p><b><u>Topics Covered</u></b></p> <ul style="list-style-type: none"> <li>▪ Bracket removal</li> <li>▪ Bracket Mounting</li> <li>▪ Charger Reassembly</li> </ul>	<p><b><u>Date Revised</u></b> <b>03/09/2023</b></p>	<p><b><u>Revision Number</u></b> 1</p>
----------------------------------	---	---	--

**Equipment and Tools Needed:**

- Drill
- T20 security bit
- Phillips head bit
- Self-taping screws (size to be determined by installer)

**Safety Precautions:**

Whenever working on an EVSE or other electrical equipment safety is the number one priority, make sure that the charger is de-energized and safe to begin work on.

**Required Safety Equipment:**

- Safety Glasses
- Safety Gloves

Table of Contents

	Pre-Commissioning	2
<b>1.1</b>	Bracket Removal .....	2
<b>1.2</b>	Bracket Mounting.....	4
<b>1.3</b>	Charger Reassembling.....	5

## Pre-Commissioning

### 1.1 Bracket Removal

After removing the ICE 80A from the box, start the bracket removal process by:

- Removing the single screw from the bottom of the unit.



- Once the first screw has been removed, you will be able to remove the cover of the front cover of the unit.
- After the cover has been removed, remove the five T20 security screws on the front face of the unit.



- Next, locate the screw that's in the bottom half of the charger in the top right corner.



- Once this screw has been removed, the bracket will slide right off the back end.

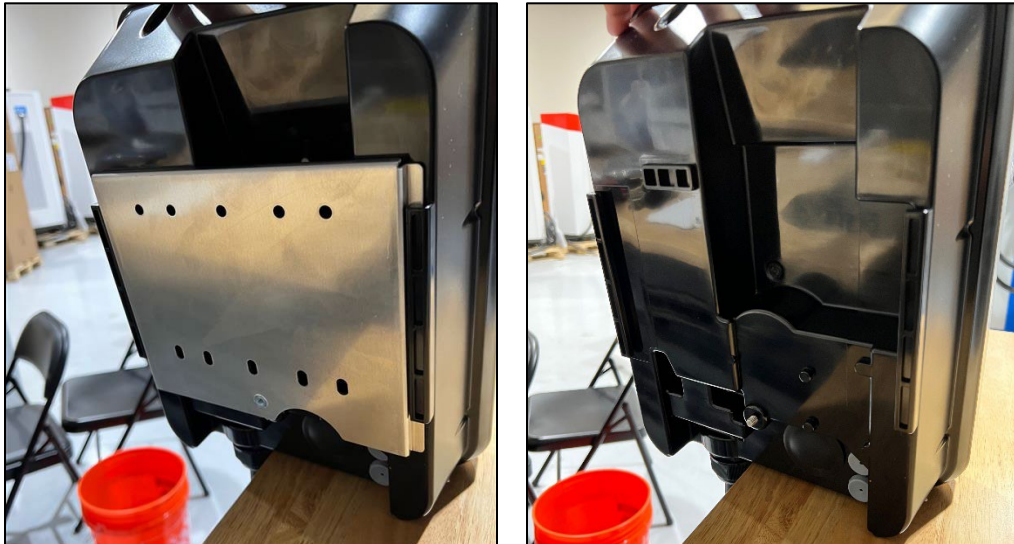

## 1.2 Bracket Mounting

After removing the bracket from the back of the ICE 80A unit:

- Hold the bracket up to the desired side of the pedestal and mark the two center holes in the desired placement of the bracket.
- **Note 1:** Make sure to leave enough room at the top for the black pedestal hole cover to be able to slide into place.
- **Note 2:** Make sure the brackets orientation is the same as what is pictured below.

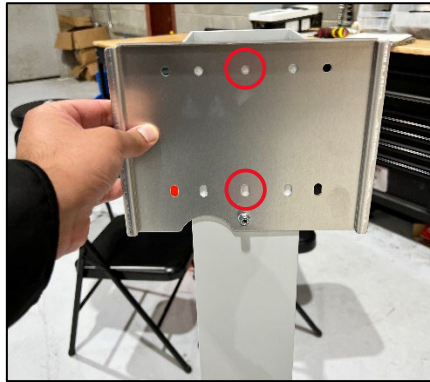

- Next, take two self-tapping screws and insert them into the marked holes to mount the bracket on the pedestal.



### 1.3 Charger Reassembling

Once the bracket has been properly mounted to the pedestal:

- Slide the ICE 80A onto the bracket.



- After placing the charger back onto the bracket, place the screw back into place and assure that the charger is secure to the pedestal.



- Next, reinstall the five T20 security screws into the front face of the charger.

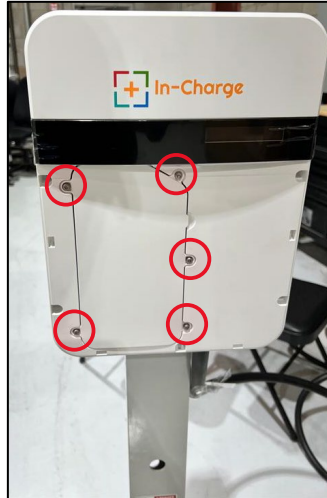

- Snap the outer cover back onto the charger and reinstall the remaining screw on the bottom lip of the charger to hold the face plate in place.

